

### Liftsystem Track

In order to achieve a correct mounting of LiftSystem Track, you are advised to read and follow the instructions step by step. If there are incomprehensible steps, please let us know and we will get back to you.

#### Part Check-List

①

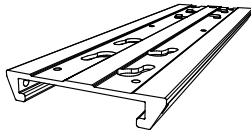

x1

②

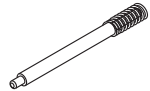

x1

③



(4x16)

x6

④



x1

- 1** Separate the LIFTSYSTEM™ cover④ from the track① by simply gripping it from the bottom and pulling.

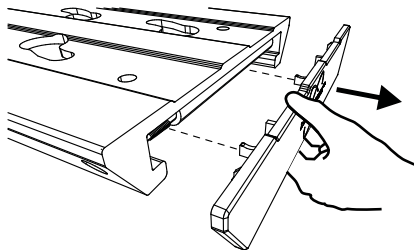

- 2** Examine the illustration below and proceed with the removal of the spring pin②. Remove from holes in two steps:



- 1** Push in direction of the spring.

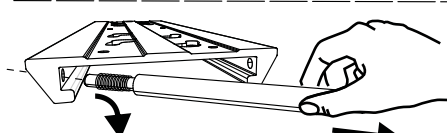

- 2** Direct outwards away the holes.

- 3** Position the track① to its planned position below the table and mount it using the screws③.

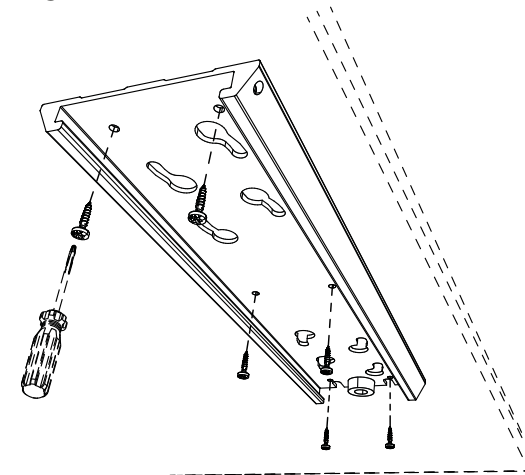

- 4** Be sure to insert the sleigh module, (e.g Laptop holder), into the track, before putting the spring pin② and the LIFTSYSTEM™ cover④ back to their respective positions.

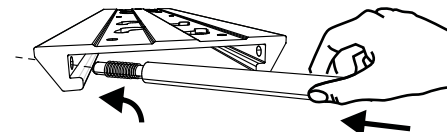

- 1** Direct inwards into the hole.

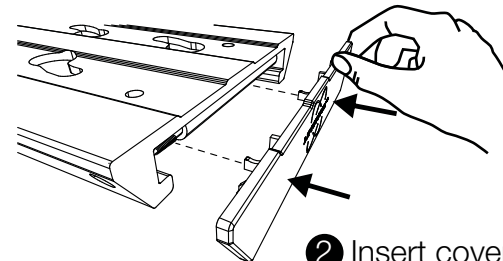

- 2** Insert cover into the track.

- 3** Done! The installation should be complete.

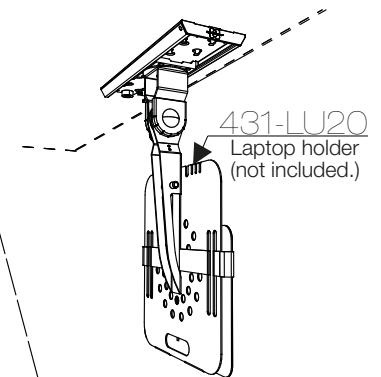

431-LU20  
Laptop holder  
(not included.)