

Elevate Dual Monitor Arm⁵⁹

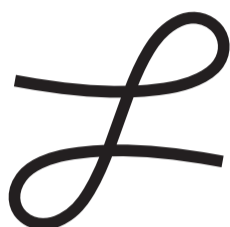

FORMINGFUNCTION .SE

PARTS AND TOOLS PART 1

(A1)	x1	PCE			
(A2)	x1	PCE			
(B1)	x2	PCS			
(B2)	x2	PCS			
(C1)	x2	PCS	M6x12		
(C2)	x2	PCS	M6x15		
(D1)	x4	PCS	M4x10	NOT NEEDED FOR DUAL MONITOR ARM	
(D2)	x4	PCS	M4x15	NOT NEEDED FOR DUAL MONITOR ARM	
(E)	x4	PCS		NOT NEEDED FOR DUAL MONITOR ARM	
(F)	x1	PCE			
(G)	x1	PCE	5mm		
(H)	x1	PCE	2mm		
(I)	x1	PCE	(NOT INCLUDED)		

FORMING FUNCTION

Before installation: Please follow the instructions. If there is a step you don't understand, please contact your sales representative. Note that all measurements and conditions must be verified on site. Neither Forming Function nor any of its distributors can be held liable for product malfunction or other defects caused by improper installation.



STEP 1

Hook the bracket (A1) into the track of your compatible aluminium profile (See STEP 2 for compatibility).

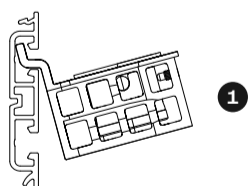

Combine bracket with monitor arm (A2) and secure its position with Allen key (H).

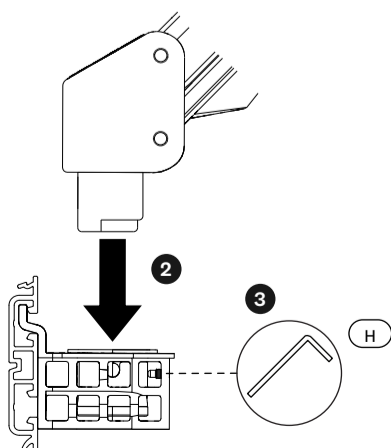

STEP 2

Identify the correct nuts and screws using the figures. Then, fixate the monitor arms to the desired position on the aluminium profile.

UNIFORM RAIL

AXESLINE TOOLBAR

OTHER POSSIBLE ASSEMBLIES

REQUIRED NUT IS NOT INCLUDED. PLEASE CONTACT FORMING FUNCTION

Insert the nut with the rounded side towards the aluminium profile.

Center and align the components before fastening the screws.

STEP 3

Attach the cover on the bottom bracket.

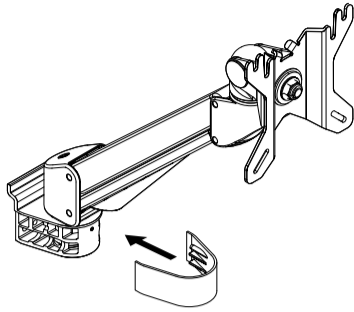

PARTS AND TOOLS PART 2

(J)	x1 PCS	
(K)	x2 PCS	
(L)	x12 PCS M4x12	
(M)	x4 PCS	
(N)	x4 PCS	
(O)	x8 PCS	
(P)	x1 PCS 13 mm (NOT INCLUDED)	

STEP 4

Mount the Dual bar to the arm. Lift the bar into monitor and pass the screws (L) through one by one. If necessary use the washers (M) and fasten using the using the nuts (N).

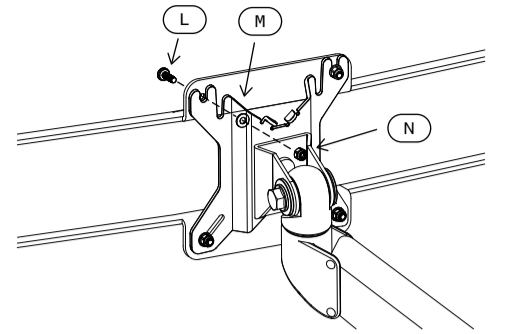

Place the monitor face down on a flat surface. Align the VESA on a flat surface. Align the VESA bracket (K) holes and fasten using screws (L). Repeat procedure for both monitors.

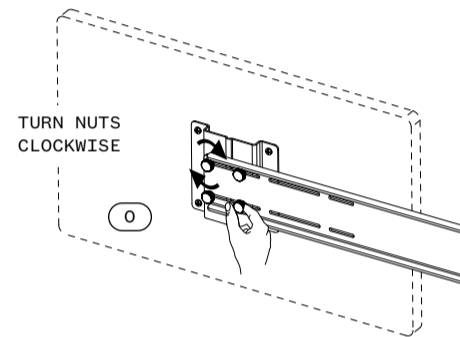
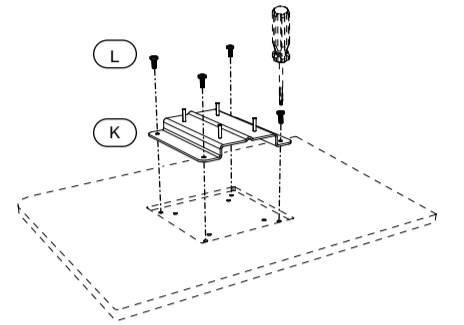

TURN NUTS CLOCKWISE

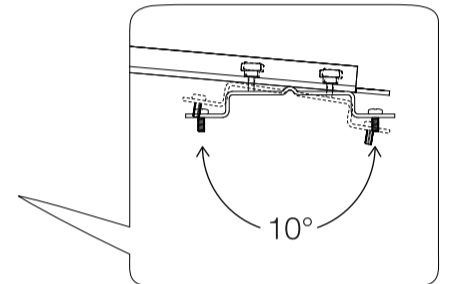

ANGLE ADJUSTMENT

Lift the VESA bracket with the mounted monitor, and examine how close the monitor can be to the center of the bar. Then, insert the VESA bracket pins into the track of the bar and lock them to the track using the knob nuts (O). Angle the monitor as you see fit. Repeat procedure for both VESA brackets.

STEP 5

Use wrench or impact wrench to tighten the bar to a vertical position, until fully rigid. Hold it up to the desired position and use the VESA bracket or bar as a gripping surface to counter the force of the wrench and gravity. This step is easiest if you are two persons:

! DO NOT SKIP THIS STEP

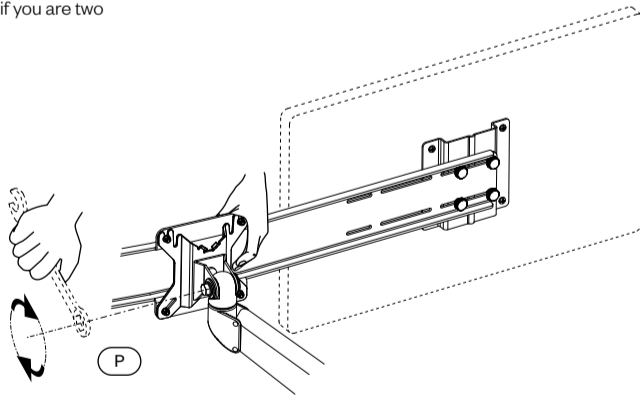

STEP 6

Detach the small cable collector and route the cables through. Once satisfied, re-attach the collector back into place.

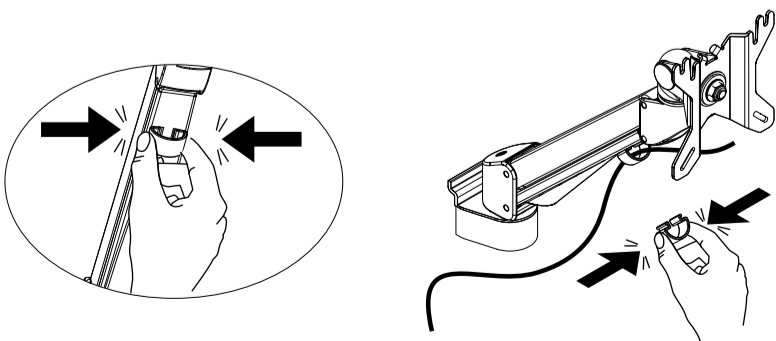

TENSION ADJUSTMENTS

CAUTION:
Support and hold on to the arm while adjusting the tension.

ADJUSTMENT:
Use the Allen key provided to adjust the tension to correspond to the weight of the desired monitor. Turn the Allen key counter-clockwise to adjust for heavier monitors; clockwise for lighter monitors. Once the adjustment is done, the monitor should be experienced as weightless and the monitor should remain in any position without dropping nor rising.

RECOMMENDATIONS:

- 8-14 kg.
- The products loading capacities are based on monitors' center of gravity less than 3 cm from the end of the VESA interface.
- Loading capacity could be reduced if the monitor size is greater than 26" or if the thickness exceeds 5.5 cm.
- All product specifications in catalogues are subject to change without notice.

