

# ELEVATE DUAL MONITOR ARM<sup>58</sup>

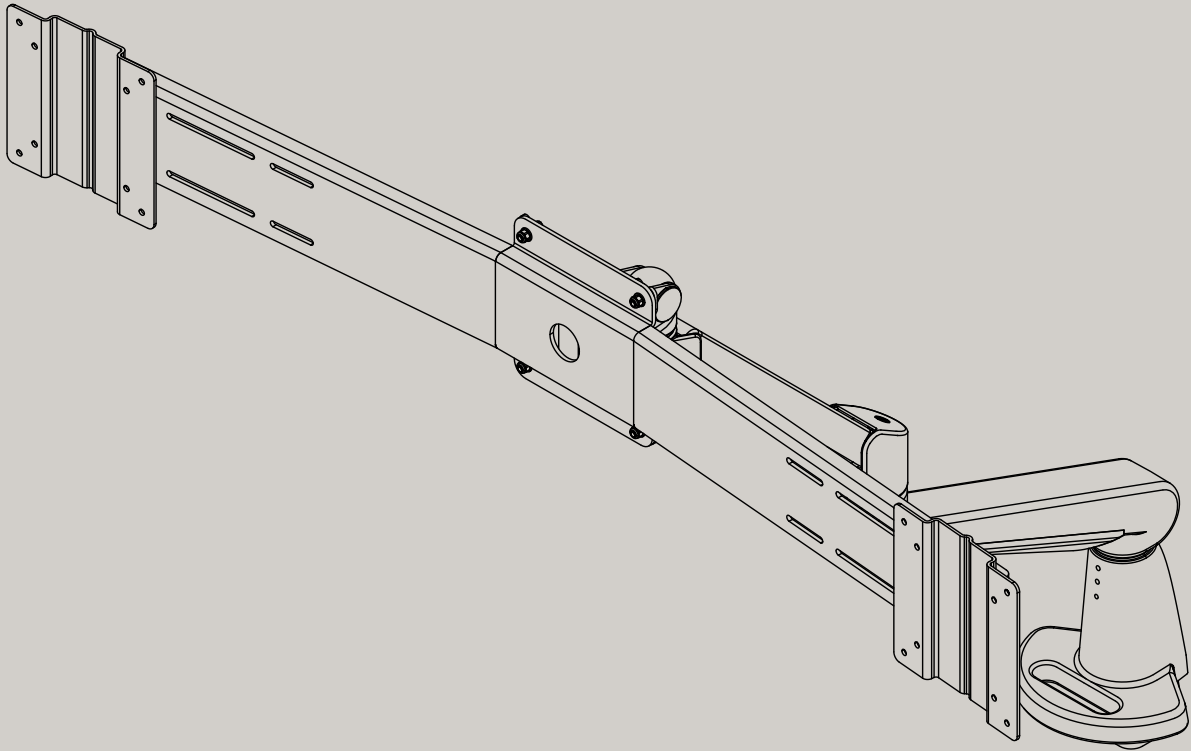

# Dimensions

See user manual for assembly instructions.

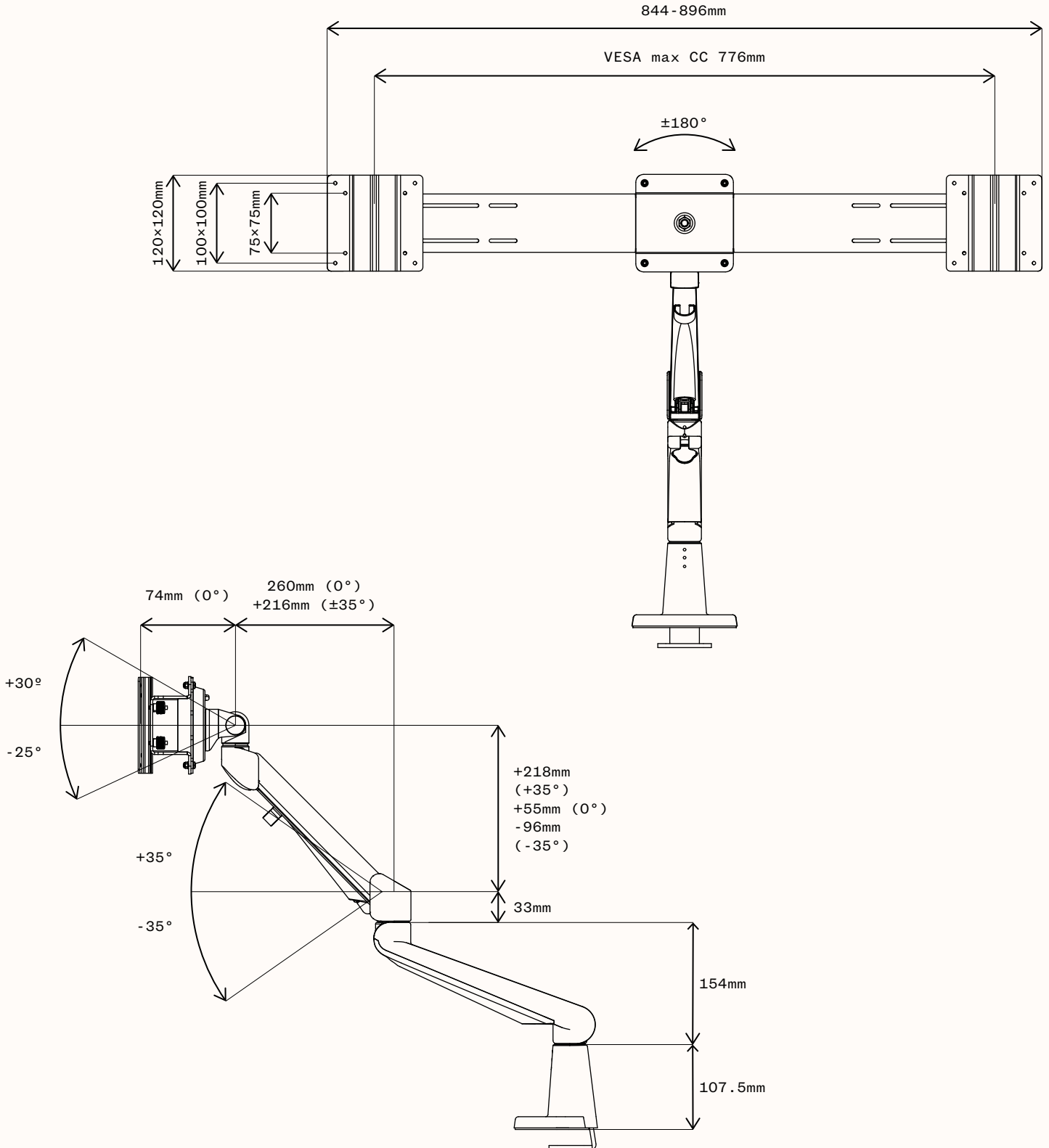

# Dimensions

See user manual for assembly instructions.

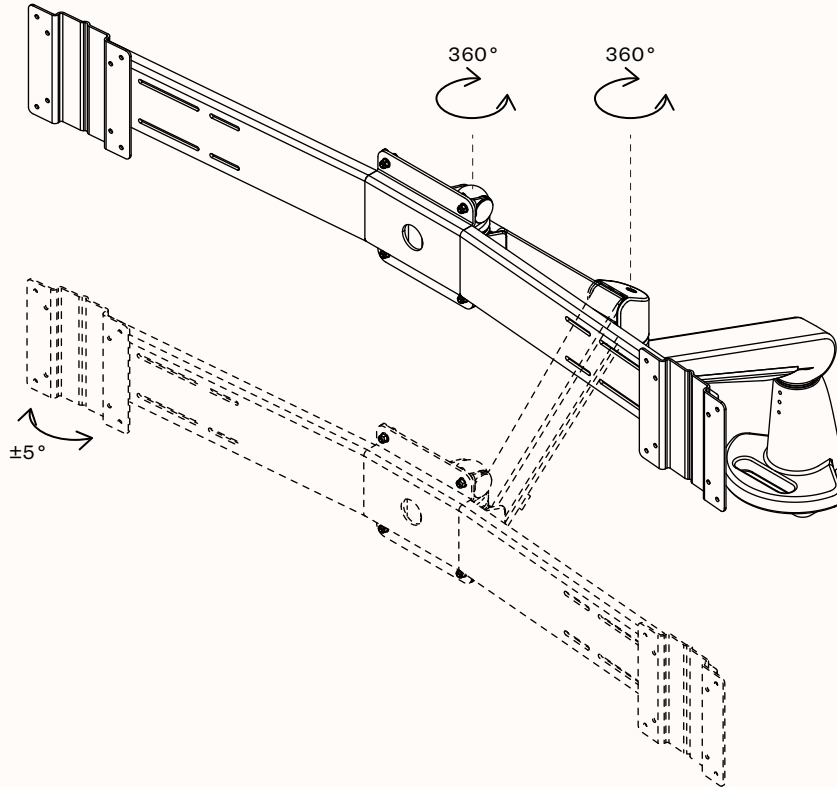

## TABLE CLAMP DIMENSIONS

Front view

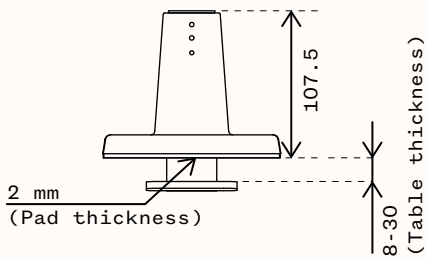

Side view

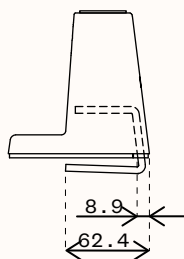

Bottom view

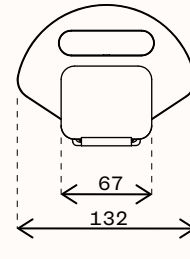

Top view

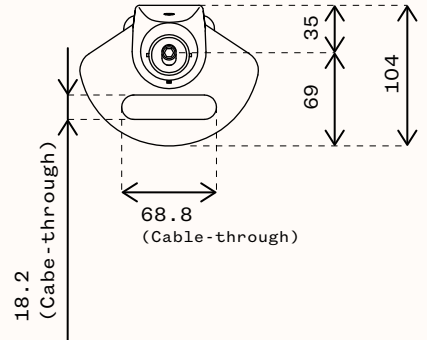

(mm)

# ELEVATE DUAL MONITOR ARM<sup>58</sup>

2x6 KG, GAS SPRING, DUAL BAR, BLACK/WHITE/SILVER

## ART. NO

4385615809	BLACK	RAL 9005
4385615801	WHITE	RAL 9016
4385615802	SILVER	

## Technical data

---

MATERIAL	ALUMINIUM AND STEEL
FINISH	BLACK/WHITE-MATTE, SILVER-METALLIC
MAXIMUM ARM LENGTH	486mm
WEIGHT SPAN	2x 3,6-6kg*
VESA	75/100mm
TABLE THICKNESS	8-30mm

\* Weight span is calculated based on monitor with Centre of Mass shorter than 30mm from VESA interface. For curved or bigger screens, the weight span might differ.