

Assembly Guide

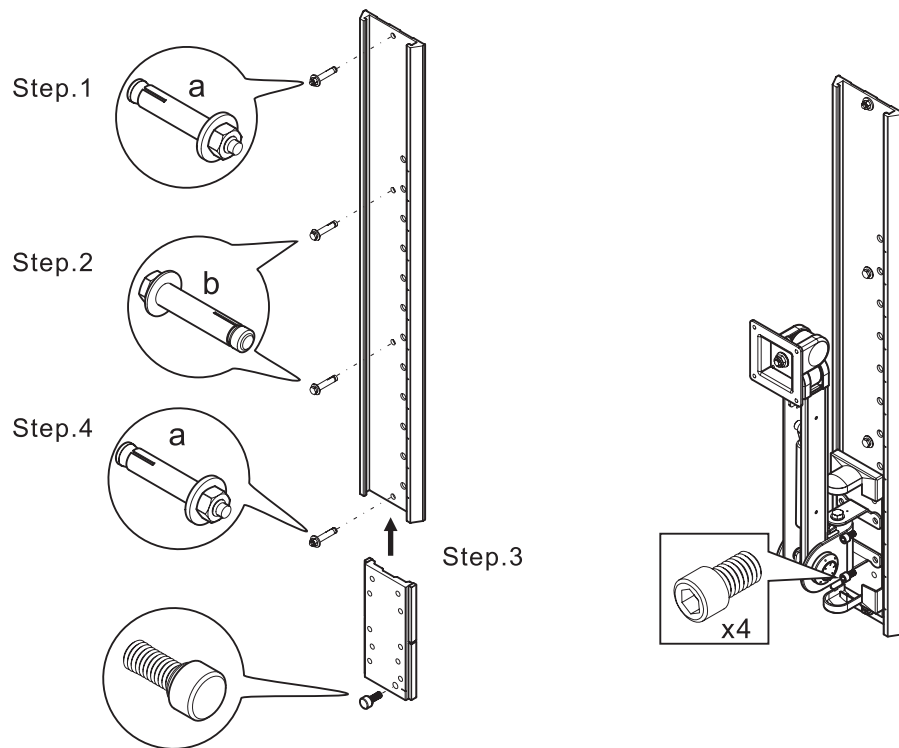

For safety, please make sure the following points have confirmed :

- The wall must be solid (not hollow)
- For convenience, make hole signs on the wall.
- Enclosed two kinds of expansion bolts, check the installation location.

Track Installation :

- Make sure it's for horizontal or vertical use, secure the big track (top end) with expansion bolt "a" to the wall.
- Use expansion bolt "b" secure the middle two holes of the big track to the wall.
- Slip the small track into the big track, secure the big track (bottom end) with expansion bolt "a" to the wall.
- Before finishing installation, secure the small track with adjusting bolt.

Install the arm to the track :

Secure the arm on the track with 4 bolts.

Adjusting the track :

- Support the arm and then loose the adjusting bolt.
- Move the small track to the location you like. After aimed the signs of the big & small tracks, tighten the adjusting bolt on.

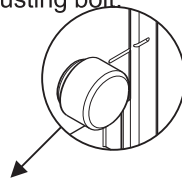

Check-List

LA-251

①

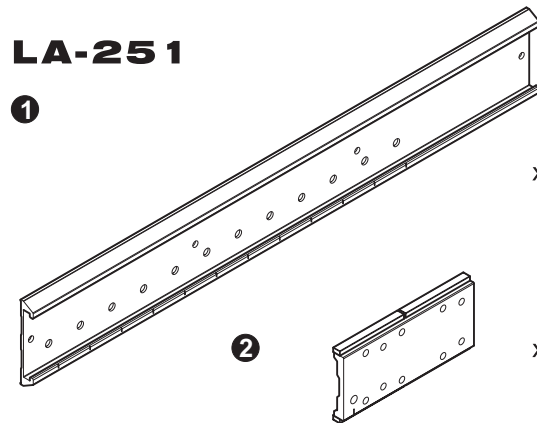

③

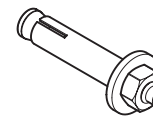

④

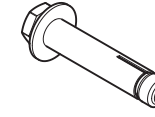

⑤

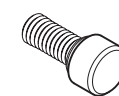

⑥

5/16"×1/2"



Before starting assembly
Please spend some times to read this assembling and follow the procedures step by step assembly guide.

Some panels are viewed differently from the exploded drawing below. This is for extra clarity. Do not discard any of the packaging until you have checked all the parts and the package of fittings. If you are missing any of the parts, please contact the store from which you purchased your products. The staff will do their best to help you.

Dimensions for LA-251

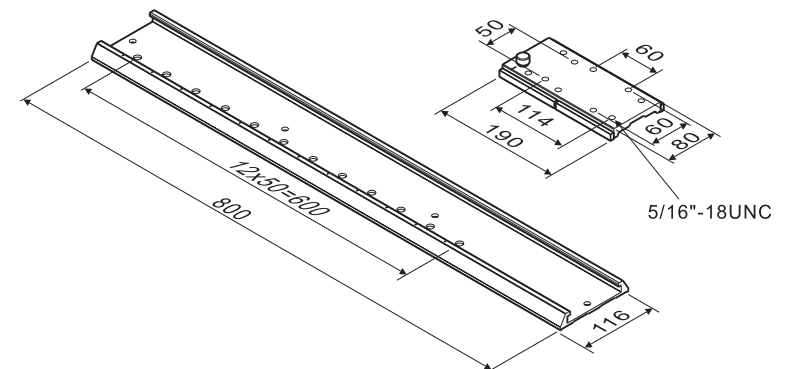

UNIT:mm

Caution:

Regular cleaning with a clean dry cloth is usually sufficient, but for stubborn marks, wipe over gently with a clean damp cloth. Never use strong detergents or abrasive cleaners as these may damage the surface finish of your furniture. There are many small components used in the construction of this unit. These loose items should be kept away from young children while assembling your unit.