

LiftPort - Port replicator holder

■ 431-LU40
□ 431-LU40W
■ 431-LU40B



INSTALLATION NOTES:

A - ABOVE DESK
(2 OPTIONS)

B - BELOW DESK

B1 ATTACH WOOD SCREWS

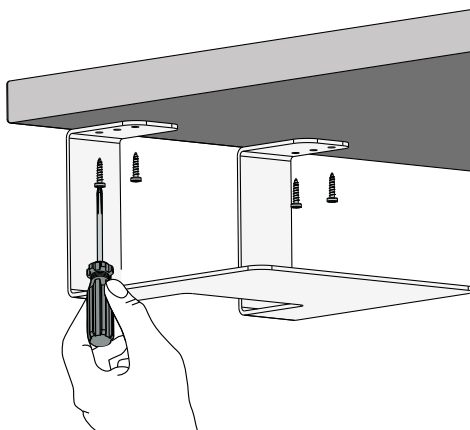

B2 ATTACH ADHESIVE FASTENERS

Attach the fasteners to the holder and to the Port replicator.

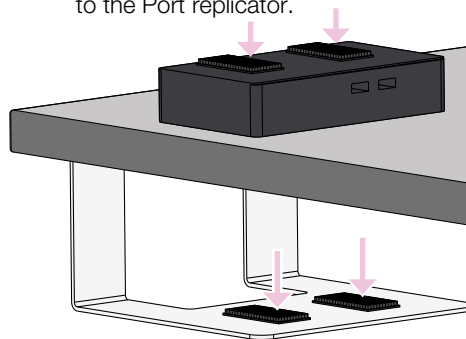

B3 PAIR AND ATTACH FASTENERS

Pair the fasteners from the holder and Port replicator. Push together to connect the fasteners.

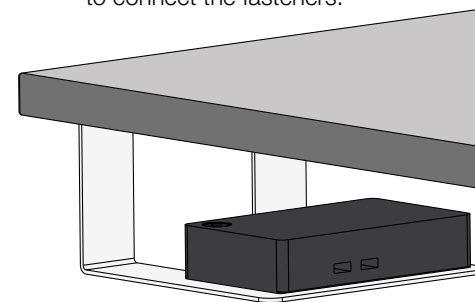

CONTENT:

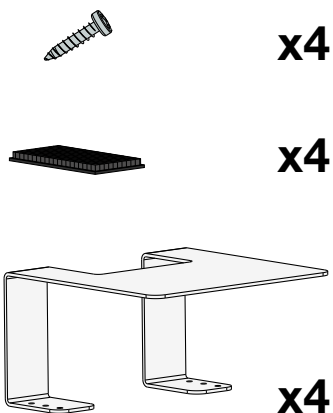

A1 ATTACH WOOD SCREWS

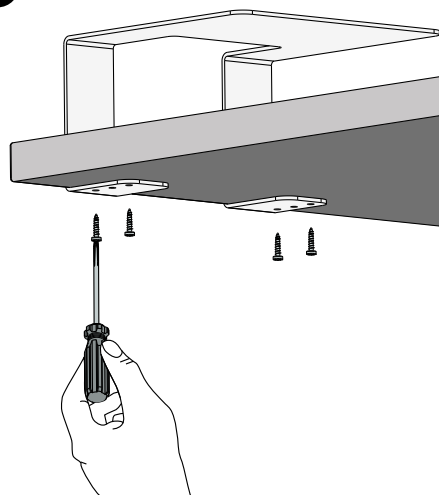

A2.1 ATTACH ADHESIVE FASTENERS

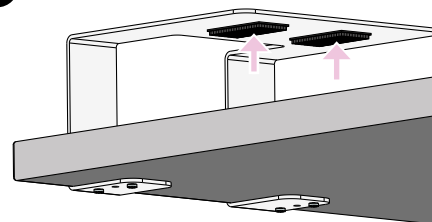

A2.2

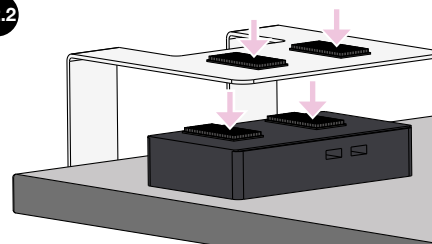

A3.1 PAIR AND ATTACH FASTENERS

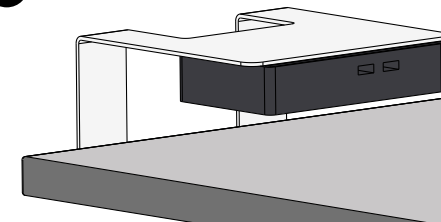

A3.2

