

QuickClick CPU Holder

□ 427-1203W

■ 427-1203

■ 427-1203B

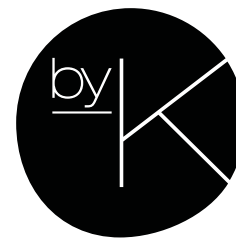

- A** - Installation for CPU:s with a width of 40 to 125 mm
B - Installation for wider CPU:s with a width of 125 to 185 mm

CONTENT:

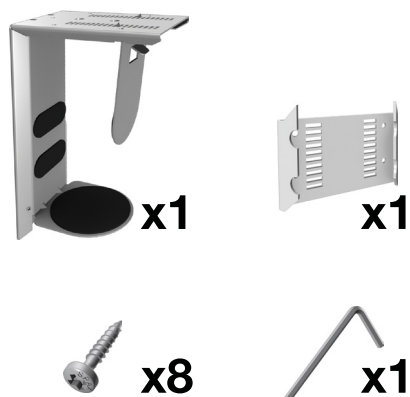

- 1** REMOVE SUPPORT BRACKET
 As you hold down the lever, pull the support bracket until completely loose.

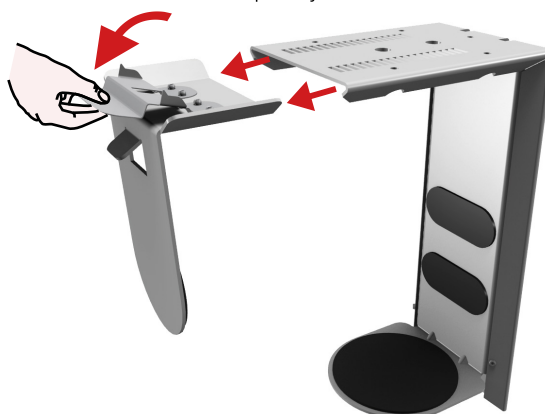

- 2** LOOSEN AND ADJUST
 Loosen screws with allen key and adjust to desired height

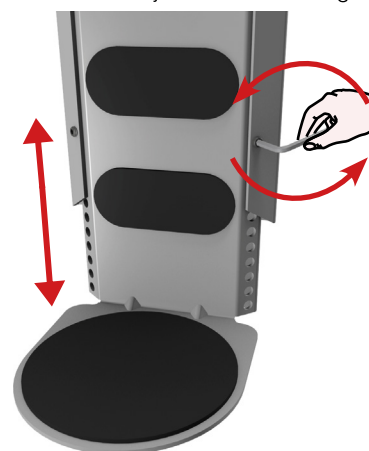

- 3** FIX VERTICAL POSITION
 Tighten screws with allen key to secure the product's height

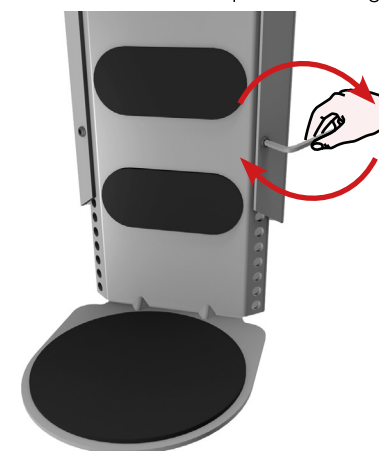

- 4a** ATTACH CPU (40 TO 125 MM)
 Using four screws, attach the CPU holder to the underside of the table.



- 4b** ATTACH CPU (125 TO 185 MM)
 For computers wider than 125 mm, attach the expansion rail to extend the product.



- 5** INSERT
 Direct the support bracket into the rail of the CPU holder - hold the lever down and push it in. Be sure to leave space for the computer.

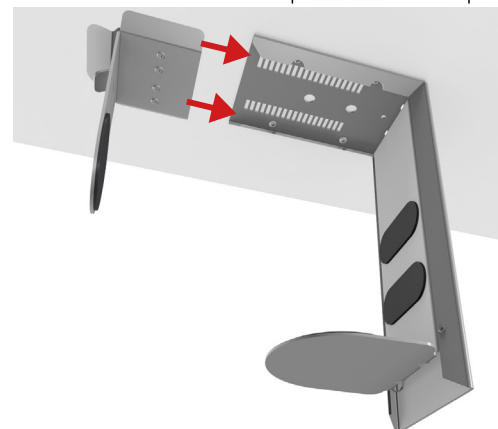

- 6** PLACE
 Place the computer in its position and secure with supporting piece

